

2 SECTION @ SOLAR PORCH
A-11 SCALE: 3/8" = 1'-0"

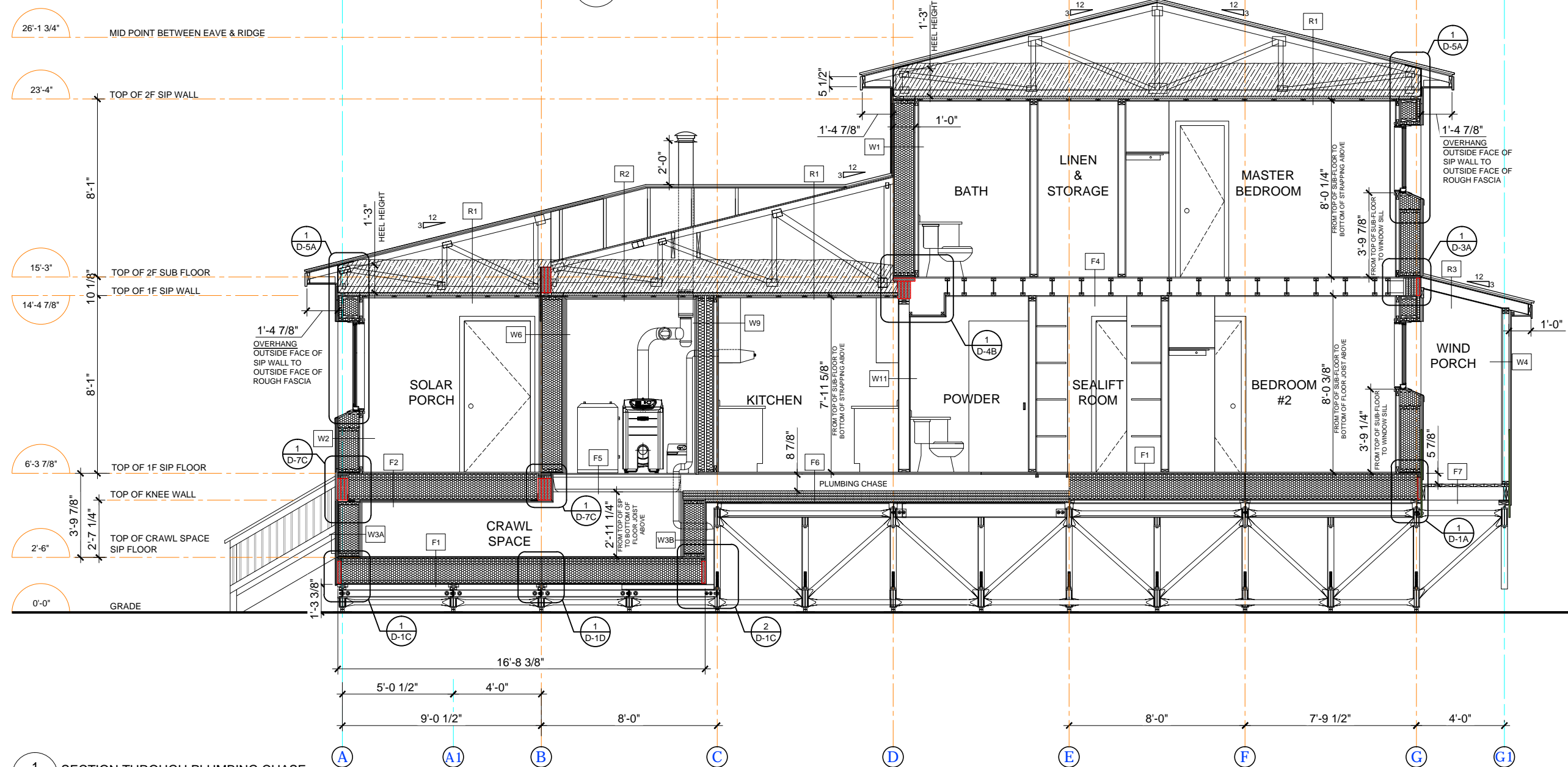

1 SECTION THROUGH PLUMBING CHASE
A-11 SCALE: 3/16" = 1'-0"

GENERAL NOTES:
 1. DO NOT SCALE DRAWINGS.
 2. VERIFY ALL DIMENSIONS IN FIELD & NOTIFY DAC INTERNATIONAL OF ANY DISCREPANCIES.
 3. THIS DRAWING IS THE EXCLUSIVE PROPERTY OF "DAC INTERNATIONAL" AND SHALL NOT BE REPRODUCED OR USED WITHOUT WRITTEN AUTHORIZATION.

No.	ITEM	DATE
29.	BULKHEAD ADDED OVER POWDER.	2011.09.07
28.	CHIMNEY ADDED OVER MECH. ROOM.	2011.08.23
27.	LOWER ROOF RIDGE HEIGHT REVISED.	2011.08.18
26.	INT. FLOOR JOIST & RM REVISED, 5/8" PLYWOOD ADDED TO INT. OF MECH. ROOM	2011.08.15
25.	ROOF BEAM & INTERMEDIATE FLOOR BEAM REMOVED, 2ND FLOOR TRUSS REVISED	2011.08.04
24.	7/16" OSB PLATE ADDED UNDER CRAWLSPACE WALLS	2011.07.28
23.	STEEL ANGLES AT CRAWLSPACE BEAMS ADDED, BEAM LOCATIONS REVISED	2011.07.28
22.	TRIODETIC FOUNDATION REVISED, BUILDING RAISED 3-7/8" DUE TO FOUNDATION	2011.07.28
23.	ADD 3 PLY 1-3/4" X 14" LVL BEAM ABOVE MECH & SOLAR PORCH WALL, REVISE OVERHANG	2011.06.28
22.	CRAWLSPACE SIDE WALLS (GRID 3A & 6A) MOVED 12" OUTWARD, AWAY FROM CENTER (GRID 5)	2011.06.28
21.	MOVE CRAWLSPACE BACK WALL 9-1/2" TOWARD FRONT, MOVE WALL BETWEEN MECH & KITCHEN 1-1/4" TOWARD FRONT OF BUILDING	2011.06.28
20.	PLUMBING CHASE EXTENDED TO GRID E	2011.06.28
19.	REVISED FOUNDATION GRID, REMOVE SIP SPLINES @ END PANEL JOINTS	2011.06.28
18.	2F FLOOR BEAM OVER POWDER ROOM REVISED FROM 2 PLY TO 4 PLY, 1-3/4" X 11-7/8" LVL PLATE ADDED ON TOP OF THIS BEAM	2011.06.24
17.	CRAWL SPACE FLOOR ASSEMBLY CHANGED TO F1	2011.06.21
16.	2X24 POST IN CRAWL SPACE MOVED FROM FACE OF SIP WALL TO INSIDE OF WALL	2011.06.21
15.	13-3/8" LVL IN FLOOR PANEL CHANGED TO 2X BLOCKING & 11-7/8" LVL	2011.06.21
14.	STEEL ANGLE CHANGED TO LVL BEAM @ FRONT	2011.06.16
13.	GRID A1 & F1 ADDED	2011.06.15
12.	MECH. WALL GYPSUM BOARD - CHANGED FROM 1/2" + 5/8" TO 2 LAYERS OF 5/8"	2011.06.13
11.	(PARTY WALL BETWEEN MECH & KITCHEN) 5/8" GYPSUM BOARD, 2X2 STRAPPING & 1/2" RESILIENT CHANNEL ADDED TO KITCHEN SIDE.	2011.06.13
10.	2X4 PARTY WALL BETWEEN KITCHEN & MECH. & CRAWL SPACE WALL MOVED 2-5/8" TOWARDS MECH. SIDE.	2011.06.13
9.	WIND PORCH FLOOR JOIST SIZE CHANGED	2011.06.08
8.	ROOF BEAM SIZE CHANGED	2011.06.08
7.	BEAM SIZE OVER CRAWL SPACE REVISED	2011.06.07
6.	2F FLOOR BEAM ADDED BETWEEN BED #2 & SEALIFT	2011.06.07
5.	ROOF BEAM ADDED IN UPPER ROOF	2011.05.30
4.	LOWER ROOF PROFILE REVISED	2011.05.30
3.	7/16" OSB ADDED TO WALL TOP/BOTTOM PLATE	2011.05.30
2.	LOAD BEARING WALL NOTE ADDED TO THE WALL BETWEEN MECH. & SOLAR PORCH	2011.05.30
1.	INTERIOR WALLS BETWEEN KITCHEN & POWDER ROOM & POWDER ROOM & SEALIFT MOVED 2-3/4" TOWARD FRONT OF DUPLEX	2011.05.20

REVISIONS

CLIENT/PROJECT NAME:
 NUNAVUT DUPLEX
 PROJECT NUMBER:
 CNUN006
 DRAWING NAME:
 SECTION #3

SCALE:	DATE DRAWN:	DRAWING NUMBER:
3/16" = 1'-0"	2011.05.16	A-11
DESIGN & DRAWN BY:	CHECKED BY:	LAST REVISION:
S.K.	J.A.	2011.09.07